

The Partridge

\$

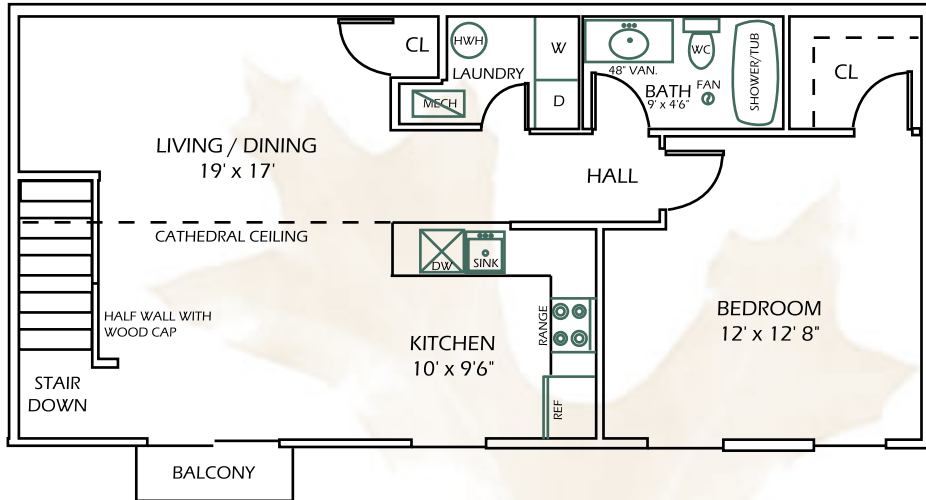

UNIT F

882 sq. ft. Living Space
 245 sq. ft. Garage
 55 sq. ft. Balcony & Porch
 1 182 Total sq. ft.

** All Rent Includes: Local and Long Distance Phone Service, High Speed Wireless Internet, & Cable TV with HBO. No waiting or hook-up fees!

All room sizes are approximate.

*** East Greenbush School District

